



**MOTOCRANE**  
**PSC**  
**PERFORMANCE SPEEDRAIL COUPLER**

Performance Speedrail Coupler (PSC)  
Operation Manual v1.0  
June, 2022

## **⚠️ WARNING**

To minimize risk of serious injury, death or damage, before using MotoCrane PSC, all drivers and operators must read this Operation Manual and all on-product labels.

All practices and procedures stated herein are required for the proper and safe operation of PSC.

If there are any questions, please contact MotoCrane Support at [support@motocrane.com](mailto:support@motocrane.com).

Keep this Operation Manual near your PSC for future reference.

## Safety Signal Words

This manual and the safety labels attached to this equipment utilize signal words that signify safety hazards with different levels of severity. The words are preceded by a triangle signifying that these are safety related. Below are the words used and the definitions for these words:

- **⚠️ WARNING** indicates a hazardous situation which, if not avoided, could result in death or serious injury or damage
- **⚠️ CAUTION** indicates a hazardous situation which, if not avoided, could result in minor or moderate injury or damage
- **NOTICE** is used to address practices not related to physical injury

The terms IMPORTANT and NOTE are also used to describe ideas for better and more efficient use of PSC.

## Contents

Safety Signal Words	2
Contents	3
Before the First Drive	4
<b>IMPORTANT PRODUCT AND SAFETY INSTRUCTIONS</b>	<b>5</b>
Safety	5
IMPORTANT: Restricted Use Statement	5
Disclaimer and Limitations of Liability	5
Limited Warranty	6
Intellectual Property	6
Intended Use of PSC	7
Parts of PSC	7
Setting up PSC	9
Known Hazards	10
Terminology	10
Transporting PSC	11
Maintenance	11
Weather & Water	11
Specifications	11
Revision History	12

## Before the First Drive

Do the following before using PSC for the first time.

1. Read this Operation Manual
2. Read the Warranty in the Terms of Sale
3. Watch the Video Tutorials at [www.motocrane.com/knowledge-base](http://www.motocrane.com/knowledge-base)
4. Recommended: Attend MotoCrane Training for in-person demonstration

# IMPORTANT PRODUCT AND SAFETY INSTRUCTIONS

## Safety

MotoCrane PSC is not a toy and can cause serious injury, death or damage if not used properly. You must exercise caution during use of the PSC to ensure a safe filming environment for everyone. This Operation Manual describes safe operation and should be read in conjunction with the online training videos or additional in-person training.

## IMPORTANT: Restricted Use Statement

PSC must only be used by trained drivers and operators 18 years of age or older when properly mounted on an appropriate motor vehicle driven on a closed course with paved or finished surfaces (for example, asphalt, concrete, or tarmac) or moderate off-road (for example, gravel or dirt roads) conditions. In addition, the speed and acceleration of the motor vehicle must not exceed system ratings for PSC as set forth in this Operation Manual.

Do not modify or adjust PSC. PSC has been calibrated before it is shipped to you. No modification or adjustment to PSC is allowed without the express written approval of MotoCrane, LLC.

## Disclaimer and Limitations of Liability

You agree that you are responsible for your own conduct and any content created while using PSC, and for any consequence thereof. You agree to use this product only for purposes that are proper and in accordance with local laws, regulations or other legal requirements.

You also agree:

1. Any part of this disclaimer is subject to change without prior notice. Refer to [www.motocrane.com/support](http://www.motocrane.com/support) for the latest version.
2. MotoCrane, LLC reserves the right of final interpretation of this disclaimer.
3. MotoCrane, LLC has no control over the use, setup, assembly, modification or misuse of PSC, and therefore no liability shall be assumed or accepted by MotoCrane, LLC for any resulting damage, death, or injury incurred directly or

indirectly from the use of PSC. By the act of use, setup or assembly, the user accepts all resulting liability.

## Limited Warranty

PSC has a limited manufacturer's warranty on parts and assembly. See the Terms and Conditions of Sale for your PSC for a complete description of this limited warranty. This Limited Warranty is incorporated by reference into this Operation Manual.

## Intellectual Property

MotoCrane™, and  **MOTOCRANE** are trademarks of MotoCrane, LLC. You may not use the trademarks of MotoCrane, LLC without express written permission. All rights reserved.

## Intended Use of PSC

The Performance Speedrail Coupler (PSC) system is designed for simple transportation, storage and configuration of various lengths of industry standard "1-½" Speedrail" which is aluminum alloy IPS pipe with an outer diameter of 1.9" (48.3mm) and Schedule 40 wall thickness (.145" or 3.7mm). The PSC System uses a non-standard through-hole design which serves to both clamp the Speedrail, and also prevents any slipping or unintended disassembly under tension.

The PSC System is intended for rigging that complies with all industry standard practices such as load triangulation and the use of appropriate structural reinforcements required for achieving proper safety factors.

## Parts of PSC System

- Performance Speedrail Coupler (PSC)
- 10pcs 48" Performance Speedrail, *if applicable*
- 4pcs 24" Performance Speedrail, *if applicable*
- PSC Hole Jig Kit for 1-½" Speedrail, *if applicable*

# Setting up PSC

Below is the proper setup sequence of the PSC

1. Insert the Speedrail tubes into the PSC and make sure holes are aligning.

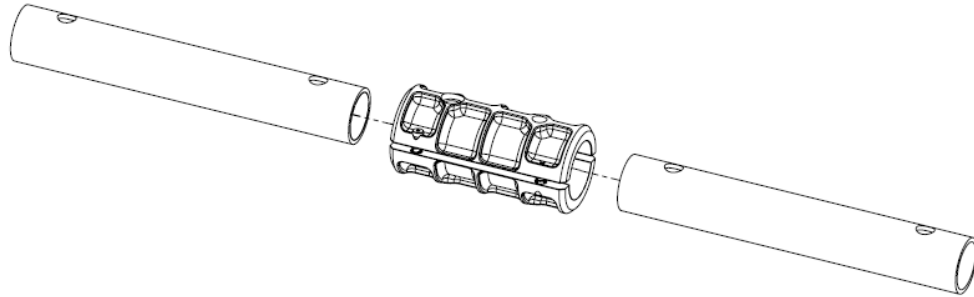

2. Insert the M12 fastener through the hole and torque it to 40ft-lbs (55Nm).

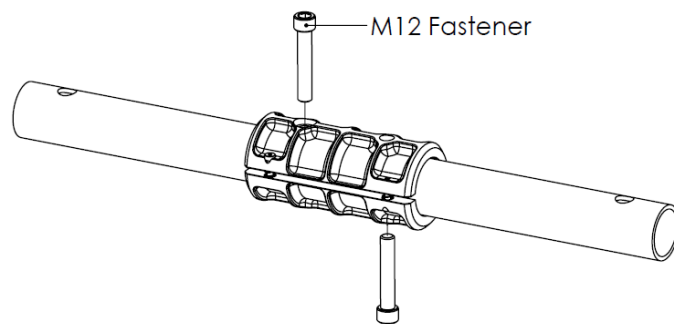

**⚠ WARNING**: Failure to follow these instructions and those below can result in serious injury, death or damage.

These instructions are demonstrated in our training videos and found online at [www.motocrane.com/support](http://www.motocrane.com/support). All terminology is referred to in the above diagrams.



# Customize existing speedrail

Below are the proper steps to drill holes for custom tubing

1. Insert the tube fully into the PSC Hole Jig and tighten the set screw knob. Use the 6mm drill bit to drill the pilot hole.

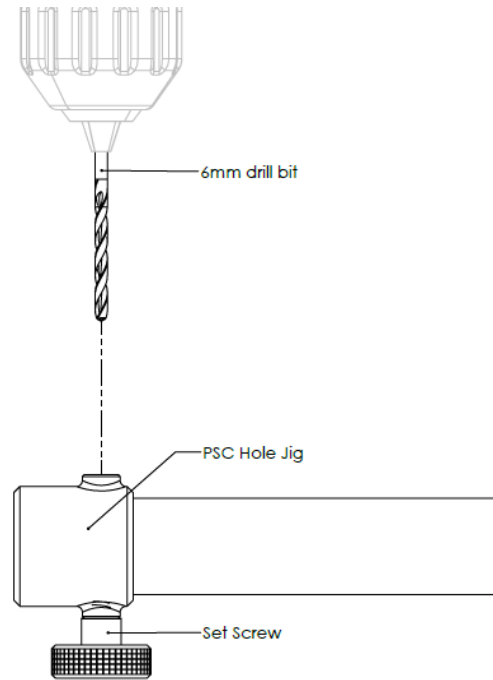

2. Loosen the set screw knob and rotate the tube to align the pilot hole with the set screw. Tighten the set screw once the hole is aligned.

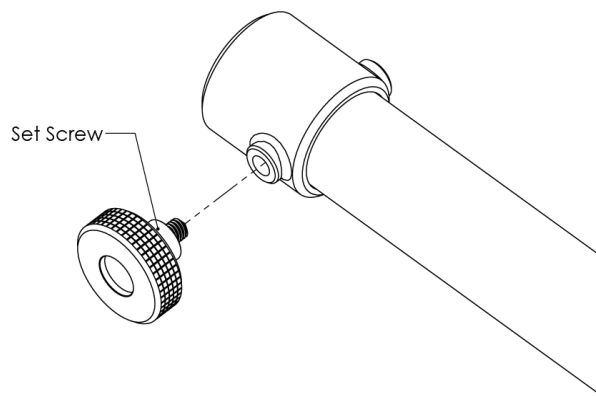

3. Use the 6mm drill bit to drill another pilot hole on the opposite side.

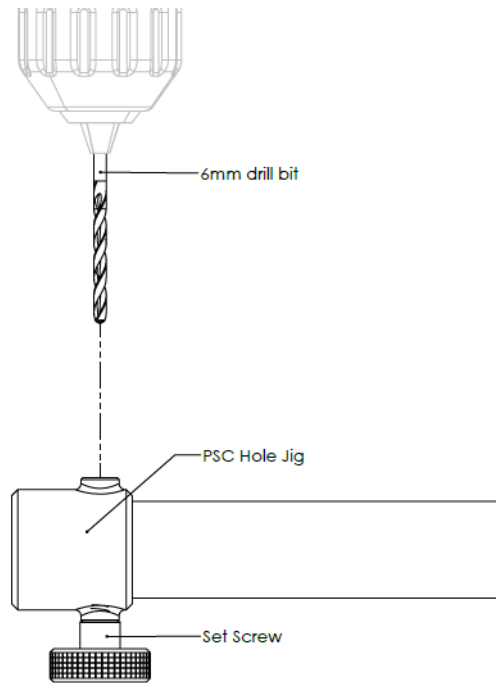

4. Use the step drill bit and drill both pilot holes to 14mm diameter.

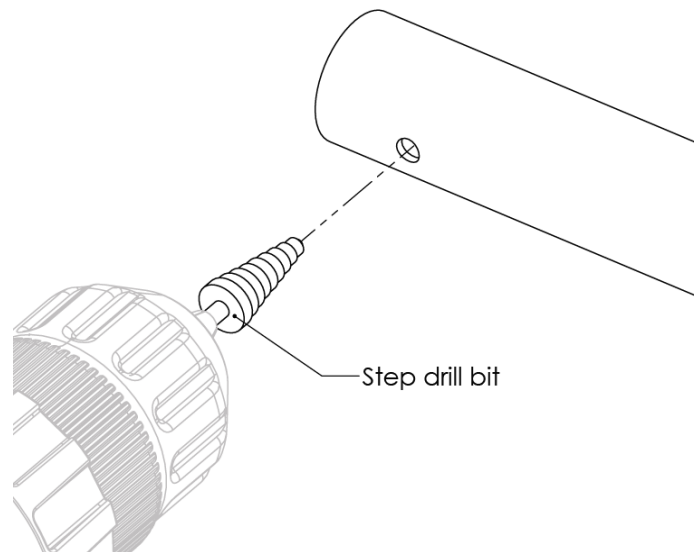

## Known Hazards

**⚠️ WARNING** The following list represents a list of known hazards that exist when operating PSC. This is not exhaustive, but represents some common hazards to watch out for.

## Maintenance

None required - contact Technical Support if you believe the unit requires service or maintenance.

## Weather & Water

PSC parts are weather resistant (IP65 rated). After using the PSC in wet or dusty conditions, wipe all components down with a soft dry cloth.

## Specifications

### Mechanical

#### Module Weight

PSC: 1.5lbs

# Revision History

Revision	Date	Description
1.0	June, 2022	Initial Release

MotoCrane Support  
[support@motocrane.com](mailto:support@motocrane.com)

This content is subject to change.

Download the latest version from  
[www.motocrane.com/support](http://www.motocrane.com/support)

If you have any questions about this document, please contact MotoCrane, LLC by sending a message to [contact@motocrane.com](mailto:contact@motocrane.com).

©2022 MotoCrane, LLC. All rights reserved.